

## Video Door Phone Quick Installation Guide

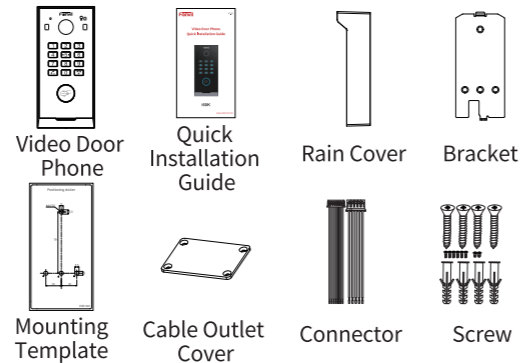

i60K

### 1) Package Contents



### 2) Physical Specification

| Model | Device Size             |
|-------|-------------------------|
| i60K  | 70.7×149.7×30mm (L*H*W) |

### 1) Panel

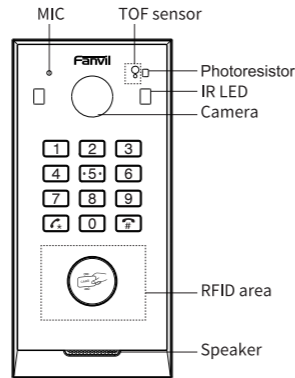

### 2) Interface Description

Open the rear case of the device, there is a row of terminal blocks for connecting the power supply, electric lock control, etc. The connection is as follows:

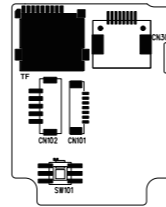

| Terminal Block | Name          | Wire Color | Description   |  |
|----------------|---------------|------------|---|--|
| CN101          | DOORA         | Red        | Two sets of short-circuit input detection interfaces: for connecting switches, infrared probes, door magnets, vibration sensors and other input devices |  |
|                | GND           | Black      |   |  |
|                | DOORB         | Brown      |   |  |
|                | GND           | Black      | Wiegand interface   |  |
|                | WG_D1         | Yellow     |   |  |
|                | WG_D0         | White      |   |  |
| CN102          | GND           | Black      | Power interface: 12V/1A input up positive, down grounded  |  |
|                | 12V+          | Red        |   |  |
|                | GND           | Black      |   |  |
|                | NC            | Yellow     |   | Short-circuit output control interface: used to control electric locks, alarms, etc. |
|                | COM           | Green      |   |  |
| NO             | White         |            |   |  |
| CN301          | Ethernet      | /          | Ethernet interface: standard RJ45 interface, 10/100M adaptive, it is recommended to use Cat5, Cat5e or Cat6   |  |
| SW101          | Tamper Switch | /          | Normally in the pressed state   |  |
| TF             | TF Card Slot  | /          | Insert TF card here   |  |

### 3) Wiring Instructions

NO: Normally Open Contact;  
COM: Common Contact;  
NC: Normally Close Contact.

| Driving Mode | Electric-lock Mode |                       | Connections |
|--------------|--------------------|-----------------------|-------------|
|              | Passive            | Electricify when open |             |
| √            | √                  |                       |             |
| √            |                    | √                     |             |
| √            | √                  |                       |             |

### Installation Instructions

#### 1) Notice

- Do not install the device in places with condensation, high temperature, grease, or dust.
- Install the unit at a suitable visual height, with a recommended height of 120~140cm. If it is installed indoors, please maintain a distance of at least 2 meters from light sources and at least 3 meters from doors and windows to avoid direct sunlight.
- Avoid violent vibration, collision and impact, which may cause damage to the internal precision components and the shell.

### 2) Installation Diagram

#### Step 1: Installation preparation

A. Check the following contents:

- KA4\*25 screw x4
- φ6\*30mm screw anchor x4
- KM3\*5 screw x2
- KM2\*6 screw x6

B. Recommended Tools

You need the following tools to perform the removal and installation procedures:

- Ph2 or Ph3 and Ph5 Phillips screwdriver, hammer, RJ45 crimping pliers
- Wall drilling impact drill, 8mm impact drill x1

#### Step 2: Drill and Install wall bracket

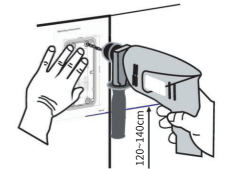

- Use the mounting template to mark the exact position of the mounting holes on the wall.
- Before marking the holes, use a spirit level or other method to verify that the template is horizontally aligned, this will ensure that the intercom unit will be mounted straight.
- Choose the appropriate drill bit and drill the holes at the marked positions, ensure the depth of the holes are 2CM.
- Insert the wall anchors into the holes, gently tap the anchors into the holes with hammer until they are flush with the wall surface.
- Position the mounting bracket over the drilled holes, ensure the holes on the bracket align with the anchors.
- Use the screws to attach the bracket to the wall, tighten the screws with a screwdriver or drill with a screwdriver bit.

### Step 3: Connect wiring

A. Connect the CAT5e cable, Power cable, Maglock cables into the slot, tighten the waterproof cover with the KM2\*6 screws.



B. If the cable outlet is too small, use diagonal pliers to cut off the cable outlet.



or



C. Place the unit from bottom to top, position the unit on the mounting bracket, use the screw to tight the unit on the bottom of bracket.

Rain cover installation

Rain cover installation

or

### 4 Searching Door Phone

Here are two methods as shown below to search the device.

#### Method 1:

Open the IP scanning tool (Device Manager), click on the scan button to obtain the IP address of door phone devices within the local network.

### 5 IP Door Phone Setting

#### Step 1: Log in the door phone

Input IP address (e.g.