



EXPLOSION-PROOF CAMERA HOUSING

SYE801

PRODUCT FEATURES

Explosion-proof mark: ExdIICT6/DIP A20 TA, T6

Applicable to Zone 0 and flammable dust atmosphere

316L 304 stainless steel and carbon steel optional

Polished finish appearance (plastic-spraying after carbon steel DACROMET is used), corrosion-proof treated internal parts

3Optional sunshield, wiper, defroster for lens and heating capability

Indoor / Outdoor applications

Design and manufacture on National GB3836-2000, GB12476.1-2000 basis

In accordance with IP68

Unit weight 10kg/6kg/4kg

Heater works automatically to keep proper temperature of inside of the housing by built-in sensor

OUTLINE DIMENSION AND INSTALLATION DRAWING

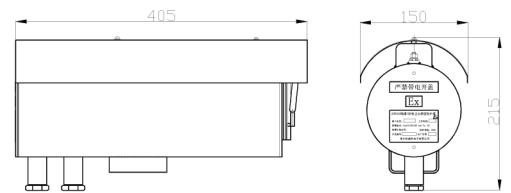

SYE800

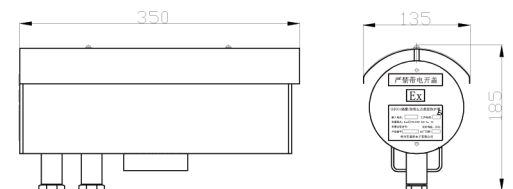
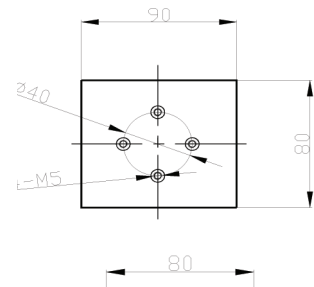

SYE801

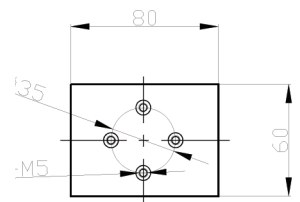

TECHNICAL DATA

Model

SYE800

SYE801

Certification Parameter

Manufacturers Standard
Configuration Mode
Explosion-proof Mark
IP
Operating Temperature
Cable Entries

<p>GB3836-2000, GB12476.1-2000 front and rear caps with threaded flameproof joints Exd II CT6 / DIP A20 TA,T6 IP68 -25°C - 60°C 2 x G1/2" Explosion-proof cable entries, Dia. of inner hole ϕ12</p>

Mechanical Features

Material
Wiper
Sight Glass Dimensions
Outside Dimensions
Inside Dimensions
Weight

Carbon steel / Stainless steel (304/316L)		
Material	Carbon steel / Stainless steel (304/316L)	
Wiper	Inside	No
Sight Glass Dimensions	ϕ 75 mm	ϕ 67 mm
Outside Dimensions	405×165×215	350×150×165
Inside Dimensions	ϕ 125×330 mm	ϕ 112×300 mm
Weight	10 Kg	6 Kg

Built-in Decoder

Controlling Device
Controlling Device
Voltage
Current
Voltage
Current

AVR singlechip with RSIC kernel
Switch Signal
12VDC
300 A
12VDC/24VDC/220VAC
1 A / 0.5 A / 0.1 A

NO

12VDC/24VDC/220VAC
1 A / 0.5 A / 0.1 A

Others

Sunshield
Optional
Cable requirement

Fitted as standard

<p>Power supply module, Inner heating Power supply: 2X1.0 mm² (24V DC) / 2x0.75 mm² (220V AC) Communication: Shield 2X0.75 mm² Video: 75 Ω</p>
--