



**Safety Technology International, Inc.**  
 2306 Airport Road • Waterford, Michigan 48327-1209  
 Phone: 248-673-9898 • Fax: 248-673-1246  
 Toll Free: 800-888-4784 • E-mail: info@sti-usa.com  
 Web: www.sti-usa.com

**Safety Technology International Ltd**  
 Taylor House • 34 Sherwood Road • Bromsgrove  
 Worcestershire • B60 3DR • England  
 Tel: +44 (0)1527 520 999 • Fax: +44 (0)1527 501 999  
 E-mail: info@sti-europe.com • Web: www.sti-europe.com

### INSTALLATION INSTRUCTIONS

1. Insert the (4) M06297T mounting tabs into the back box slots.
2. Using the back box as a template, place against the mounting surface and mark the location for the mounting screws.
3. Drill (4) 1/4 in.(6.3mm) diameter holes.
4. Insert the (4) plastic anchors provided into the wall.
5. Mount the back box to the wall using the (4) #10 x 1-1/2 in. screws.
6. Connect conduit and pull wire into the back box.
7. Mount the cover assembly to the back box using (4) #8-32 x 3/4 in. socket head screws and (4) #8 flat washers.
8. Lift the cover and pull wires through the cutout of the mounting plate and attach them to the device to be mounted.
9. Mount the device using the (2) #6 x 5/8 in. tapping screws.
10. Close the cover by aligning the (2) tabs on the top of the mounting plate and rotate the cover down to close.

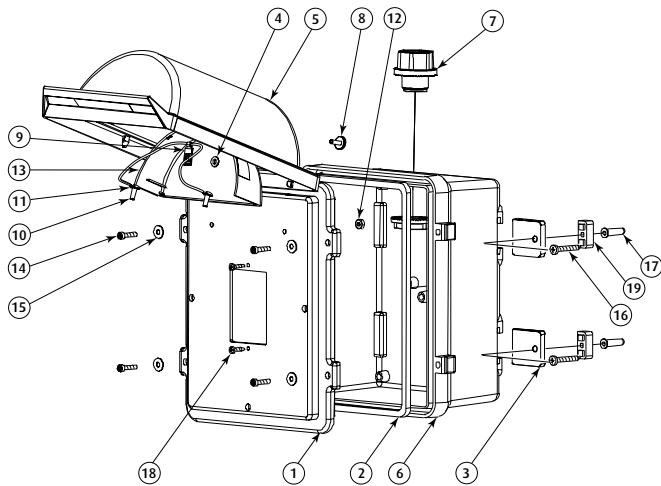

ITEM	PART NUMBER	DESCRIPTION	QTY
1	AP1200-A	06297 SERIES BACKBOX COVER MACHINED TO SPEC.	1
2	G629761A	NEOPRENE GASKET FOR 06297 SERIES BACKBOX	1
3	M06297T	WALL MOUNT TAB	4
4	SUB-51	05101 HORN HOUSING WITH "IN CASE OF FIRE..." LABEL	1
5		01002 BUBBLE COVER WITH "LIFT HERE" LABEL	1
6	M06297A-M	"A" BACKBOX WITH (1) CONDUIT HUB HOLE MILKY WHITE	1
7	KIT-H18021	3/4 in. NPT NEMA 4X CONDUIT HUB	1
8		#8-32 x 5/8 in. BUTTON HEAD SCREW WITH SEALING WASHER	1
9		#8 U-TYPE NUT	1
10		#8-32 x 1/2 in. TRUSS HEAD TAMPER SCREW	2
11	H18056	SOLDERLESS WIRE CRIMP CONNECTOR WITH EYE LOOP	2
12		#8-32 KEPS HEX NUT	2
13	SUB-05T	LANYARD	1
14		#8-32 x 3/4 in. SOCKET HEAD CAP SCREW	4
15		#8 FLAT WASHER	4
16		#10 x 1-1/2 in. PHIL PAN HEAD SCREW	4
17		#10-12 PLASTIC ANCHOR	4
18		#6 x 5/8 PHIL PAN HEAD HILO TAPPING SCREW	2
19	M629763	1/2 in. BACKBOX TAB SPACER	4

**IMPORTANT NOTE: FOR WET OR WASHDOWN AREAS, STI RECOMMENDS DRILLING (2) 1/8 in.(3mm) DIAMETER WEEP HOLES IN THIS AREA TO PREVENT THE BUILD-UP OF WATER INSIDE THE ENCLOSURE WHICH MAY CAUSE DAMAGE TO ELECTRONIC COMPONENTS**

**AVIS IMPORTANT: DANS LE CAS DES ZONES HUMIDES OU À APPLICATIONS SANITAIRES, STI RECOMMANDE LE PERÇAGE DANS CES ZONES DE DEUX (2) BARBACANES DE 1/8 PO (3 MM) DE DIAMÈTRE AFIN D'ÉVITER L'ACCUMULATION D'EAU DANS LE BÔÎTIER, CE QUI RISQUE D'ENDOMMAGER LES COMPOSANTS ÉLECTRONIQUES**

### CLEANING INSTRUCTIONS

1. Rinse cover with water to remove abrasive dust and dirt.
2. Wash with soap or mild detergent using a soft cloth. (DO NOT SCRUB.)
3. Rinse once more, then dry with a soft cloth or chamois.
4. To remove grease or wet paint, rub gently with a cloth wetted thoroughly with naphtha, then wash and rinse. (DO NOT USE RAZOR BLADES.)

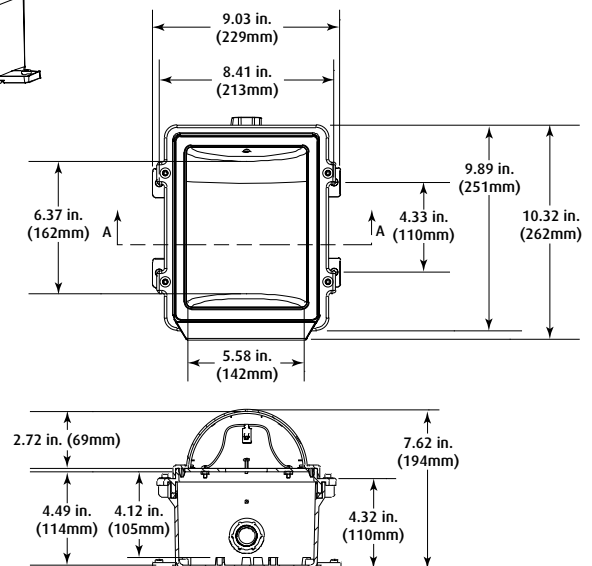
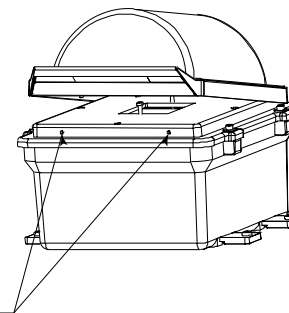

Three year warranty or a one year limited warranty (from date of purchase) on most products. See website for details. Electronic warranty form at [www.sti-usa.com/wc14](http://www.sti-usa.com/wc14).



## INSTALLATION OF STI-1200A STOPPER II® with "A" BACK BOX

All specifications and information shown were current as of publication and are subject to change without notice.

1200AIS MAY2007