

# Smart Video Lock SL50 Quick Guide

## Usage Guidelines

⚠ Keep your password confidential and change it regularly.

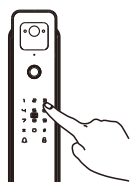

⊘ Do not use the lock with wet hands. Avoid exposing the lock to any liquids.

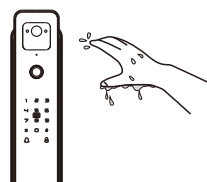

⊘ Do not use excessive force or sharp objects to press the keypad.

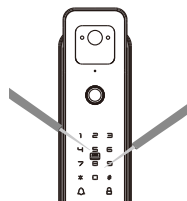

⚠ Any credentials can unlock the door after a factory reset. Set up an admin ASAP for security.



⊘ Do not forcibly pull out the device to avoid damaging the product.

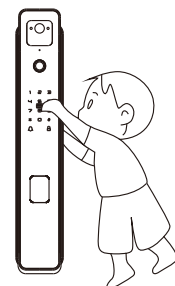

⚠ Install the lock in a sheltered area to protect it from rain.

Operating humidity: 20% - 93% RH (non-condensing)  
Operating temperature: -25°C to +70°C  
Storage humidity: 45% - 90% RH (non-condensing)



## Maintenance Guidelines

⚠ Be sure the battery terminals are connected properly.

⚠ Clean with water only. Avoid chemicals.

⚠ Replace or recharge the battery within one week after the low battery alert sounds.

⊘ Only use batteries that meet the specified requirements.

## Product Overview

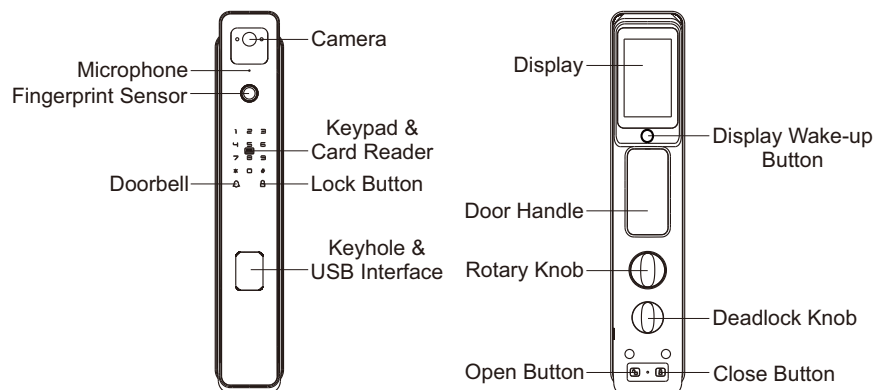

## In the Box

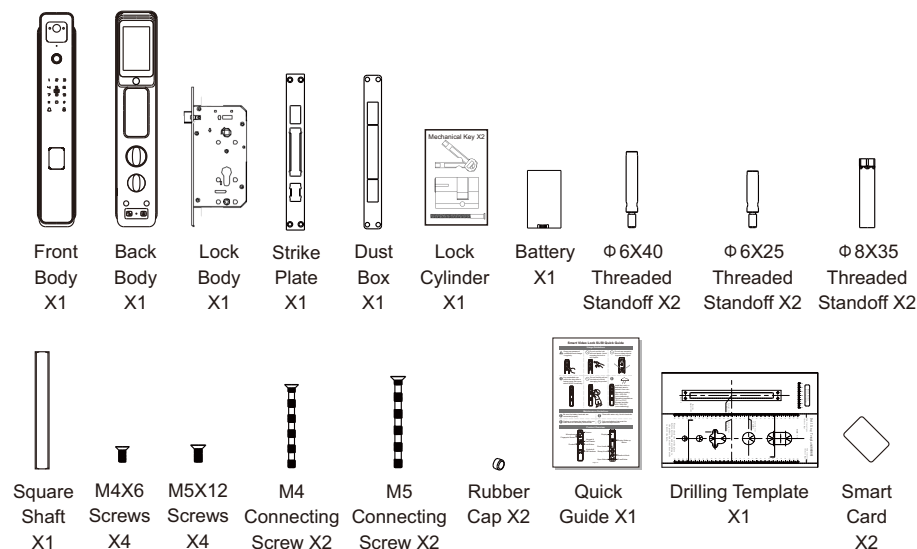

## Installation

Before installation, be sure to read and fully understand all instructions.

### Step 1 Reverse the latch

If the latch bolt needs adjustment for the door's opening direction:

1. Position the lock body upright with the latch facing upward.

2. Follow the steps shown in the figure:

- ① Push the stopper to the right.
- ② Press the latch fully down beneath the faceplate, then rotate it 180°.
- ③ Release the latch to let it pop out.

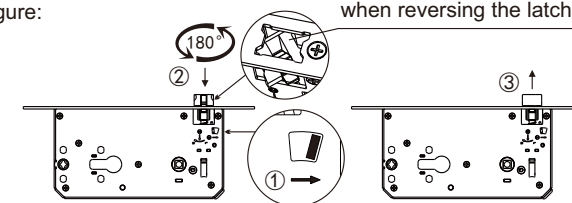

**NOTE:** This end must be lower than the faceplate when reversing the latch.

### Step 2 Install lock body

1. Mount the lock body and fix it with four screws.

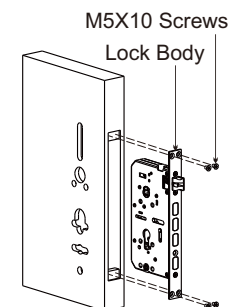

2. Insert the lock cylinder into the lock body with the keyhole facing outward. Secure it using the screw. The cylinder spindle should protrude approximately 25mm beyond the surface of the door.

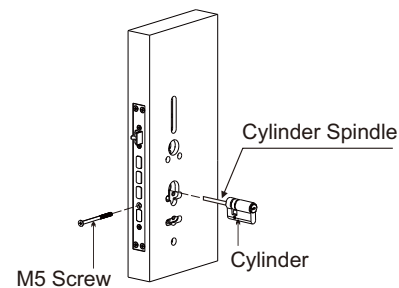

### Step 3 Disassemble back body

Disassemble the back body of the lock into the following components:

- Display (Press the bottom center and push upward to remove)
- Main body
- Mounting Plate

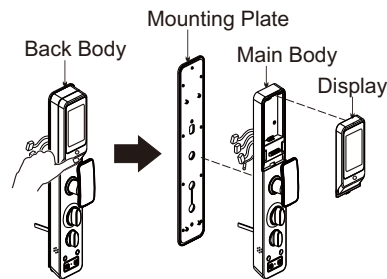

### Step 4 Install front body

1. Install the threaded standoffs on the front body.
2. Guide the cable assembly through the cable holes in the door and mounting plate.
3. Secure the mounting plate with four connecting screws (cut to fit the door thickness).

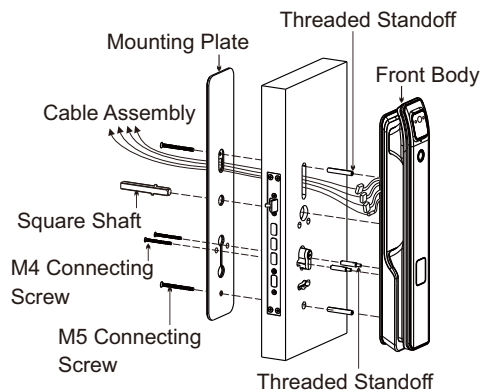

4. From inside the door, insert the locator end of the square shaft into the square hole of the lock body until it reaches the locator position. The shaft should protrude approximately 28mm beyond the surface of the door.

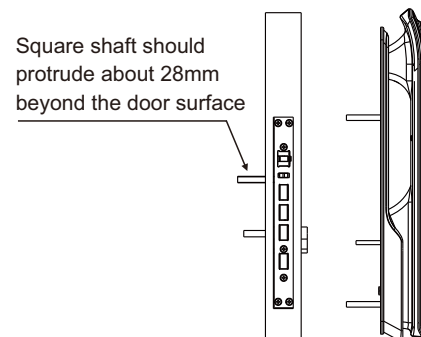

### Step 5 Install back body

1. Connect the front body's cable assembly to the back body, and tuck the extra cables into the door hole.
2. Verify if the knob spindle match the door thickness. The knob spindle should protrude approximately 15mm beyond the door surface.
3. Attach the back body to the mounting plate using four screws, then insert the rubber caps.
4. Install the battery and display.

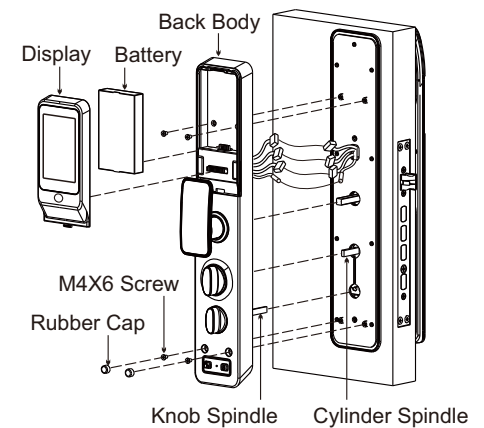

### Step 6 Install dust box and strike plate

1. Attach the dust box and the strike plate to the door jamb using four screws.
2. Verify the following:
  - Ensure the latch moves smoothly.
  - Test locking and unlocking with the card, mechanical key, and other methods to ensure all functions work properly.

