

NTL-SF150: Exit Filter



NTL-SFF150: Filter Fan



Product Applications:

Our products are widely used in the control panels, junction boxes, power distribution box, automation equipment, electronic and power device, welding machine, packing and

Normal Color: RAL 7035, RAL 7032, (other color can be customer made)

Technical Data

NTL-SFF150	
Axial fan, ball bearing	service life L10 at +40°C (+104°F): min. 37,000 h fan body aluminium, rotor metal
Connection	2 stranded wires, 160mm
Enclosure cut-out	125 x 125mm
Mounting frame	Fast Fixing with clips for different size thickness of cabinet and enclosure, no need screw fixing
Filter mat	G4 acc. to DIN EN 779, filtering degree 94%
Filter material	New ABS material confirm to RoHS, Fireproof or not fireproof can be choose
Operating/Storage temperature	-40 to +70°C (-40 to +158°F)
Operating/Storage humidity	max. 90% RH (non-condensing)
Protection type/Protection class	IP54 / I (earthed)
Note	other voltages on request

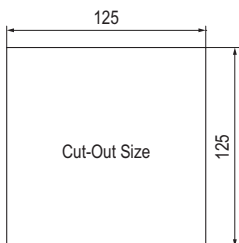
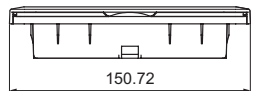
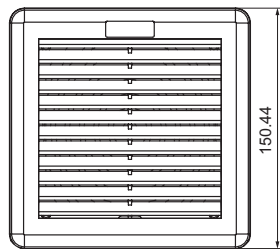
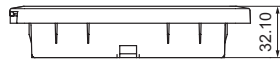

Technical Parameters

Model	Power Supply	Net Weight (kg)	Fan Size Matched (mm)	Air Flow Rate (free blow) (m³/h)	Power Consumption (W)	Current Consumption (A)	Noise Level (dBA)	Dimensions (mm)
NTL-SF150	-	0.111	without fan	-	-	-	-	150×150×32.1
NTL-SFF150-230A	230VAC	0.466	120×120×25	96/112	14/12	0.07	39/42	150×150×67.1
NTL-SFF150-230B	230VAC	0.596	120×120×38	138/162	19/15	0.11/0.105	43/48	150×150×80.1
NTL-SFF150-110A	110VAC	0.466	120×120×25	96/112	14/12	0.07	39/42	150×150×67.1
NTL-SFF150-110B	110VAC	0.596	120×120×38	138/162	19/15	0.11/0.105	43/48	150×150×80.1
NTL-SFF150-12	12VDC	0.3628	120×120×38	179.76	7.2	0.6	48	150×150×80.1
NTL-SFF150-24	24VDC	0.3628	120×120×38	179.76	9.6	0.4	48	150×150×80.1

Normally is airflow direction "Out", if you need airflow direction "In", when place order, please advice.