

Installation Precautions

- Make sure that the installation place can endure at least 4 times of the total weight of the Wall&Pole Mount and Camera.
- Each anchor screw must be capable of withstanding an extraction force of 700 kg.

Installation

Package

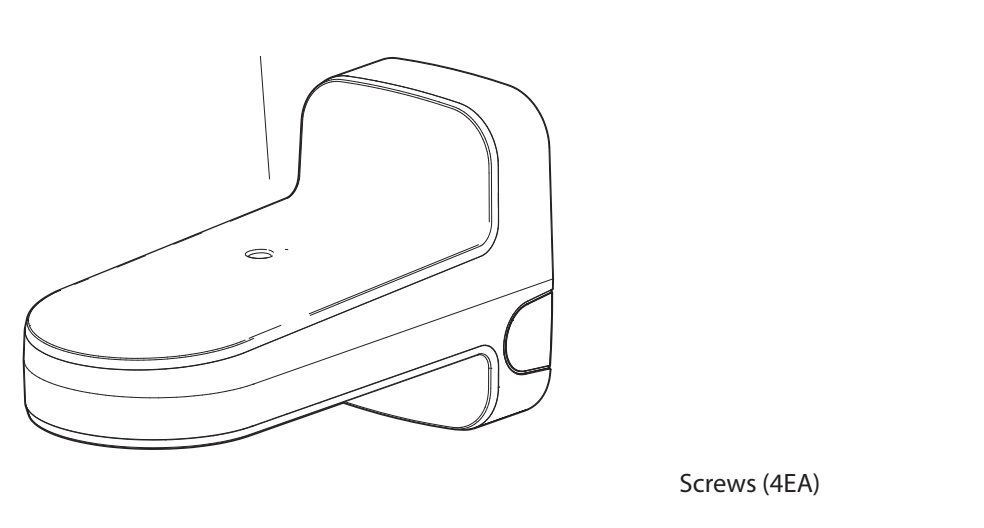

Mounting Hole Guide

Optional Accessory



When using conduit (3/4")

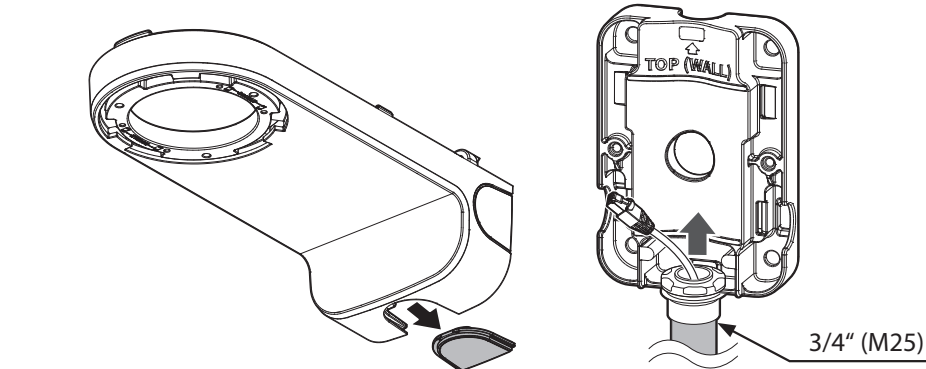
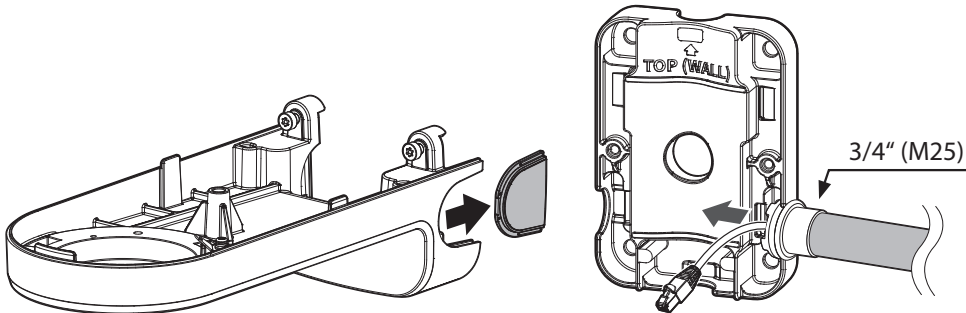

❖ If installed on a pole, conduit installation is only possible at the bottom.

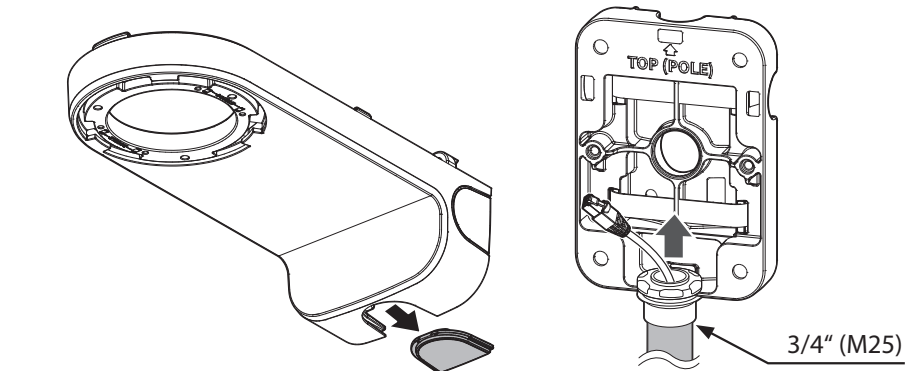

3

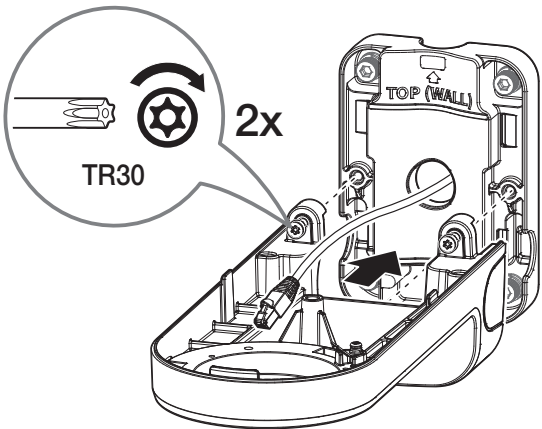

4

