



# FOR USE WITH PANDUIT SURFACE RACEWAY ROUTING SYSTEM

## DROP CEILING / ENTRANCE END FITTING

Panduit Part Number: DCEFX

### INSTALLATION INSTRUCTIONS

©Panduit Corp. 2005

Printed in U.S.A.

Low voltage or power applications up to 600 V

1/2", 3/4", & 1" breakouts

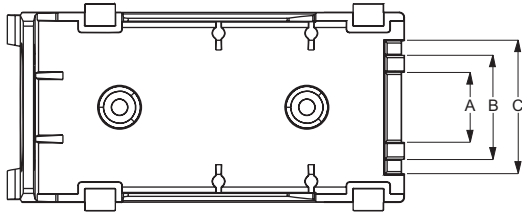
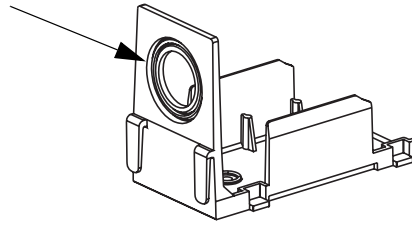
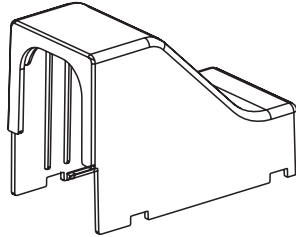

Base Breakouts	Surface Raceway
A	LD3, LDPH3, LDS3
B	LD5, LDPH5, LDS5
C	LD10, LDPH10

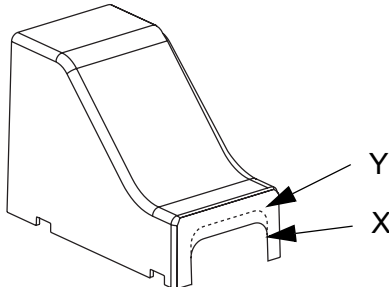

Cover Breakouts	Surface Raceway	Adapters
X	LD3, LDS3, LDPH3 LD5, LDS5, LDPH5	CA3 CA5
Y	LD10, LDPH10	N/A

The mounting hardware used to secure the fitting shall be appropriate for the mounting surface.

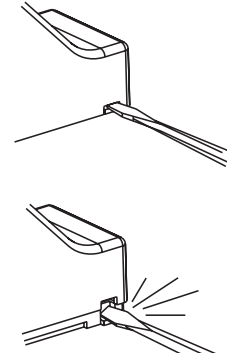
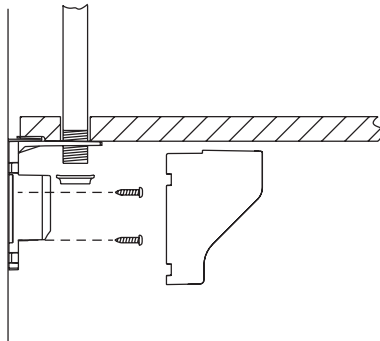
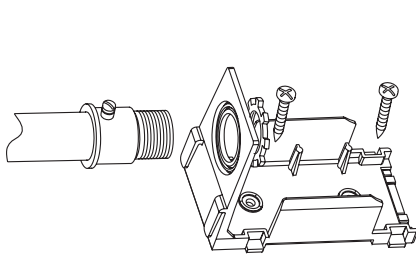

Instruction Sheet RW96

#### WORLDWIDE SUBSIDIARIES AND SALES OFFICES

17301 Ridgeland Avenue  
Tinley Park, IL 60477-3091  
Web Site: [www.panduit.com](http://www.panduit.com)



Technical Support: 866-405-6656  
Fax: 866-449-1702  
Email: [netconnsupport@panduit.com](mailto:netconnsupport@panduit.com)