

JWL®

FICHA TÉCNICA

LUMINARIO DE LED UFO



JLRE-UFO100



JLRE-UFO150



JLRE-UFO200

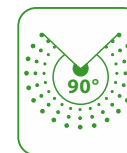

JLREUFO-100

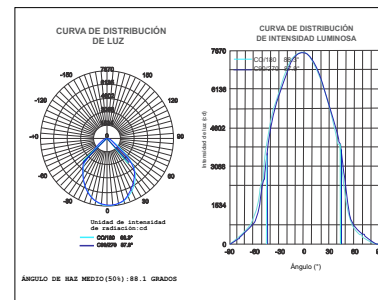

JLREUFO-150

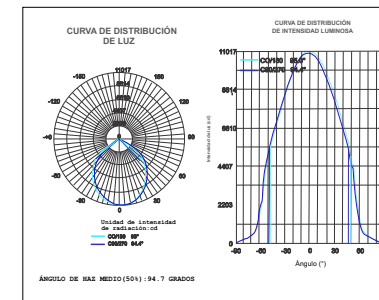

JLREUFO-200

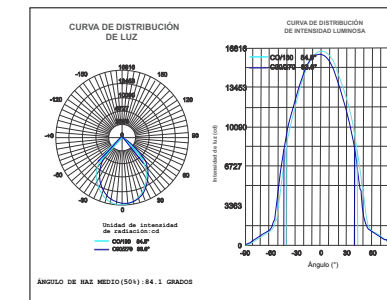

ESPECIFICACIONES ELÉCTRICAS

MODELO	POTENCIA	CORRIENTE ELÉCTRICA	FLUJO LUMINOSO
JLRE-UFO100	100W	455mA	14000 lm
JLRE-UFO150	150W	680mA	21000 lm
JLRE-UFO200	200W	930mA	28000lm

DIMENSIONES
(Ø)260mm x 130mm(alto)
(Ø)325mm x 140mm(alto)
(Ø)500mm x 150mm(alto)

Dimensiones

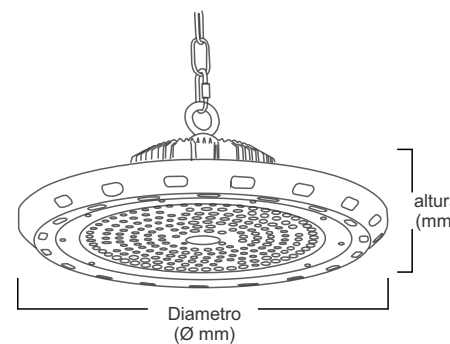

Diagrama de Instalación

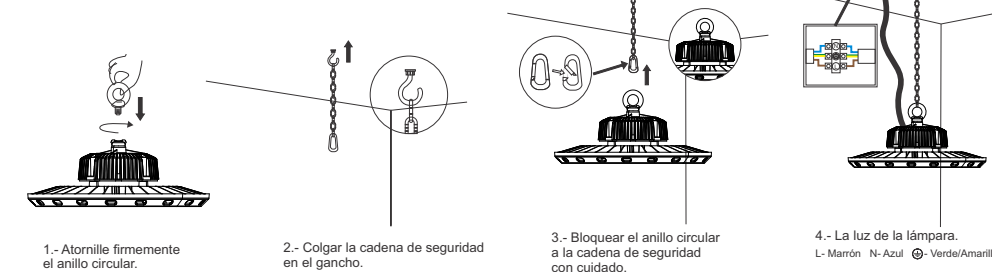

NOM

NOM-003-SCFI-2014