

1. Checking

1. Open the package and take out all the accessories.
2. Check the quantity of all parts inside according to the package list.

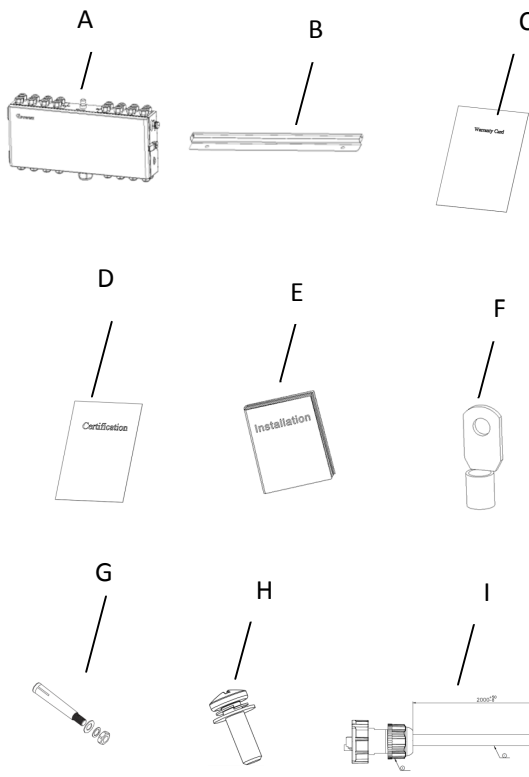

Serial number	name	Quantity
A	ARK-LV HUB-A1	1
B	Wall Hangers	1
C	Warranty Card	1
D	Certification	1
E	Installation Guidance	1
F	M6 terminal	16
G	M6 explosive screw	2
H	M4x14 Combination screw	2
I	Communication line to PCS (Optional)	1
J	key	2

2. Installation Process (Wall-Mounted)

2.1 Installation Location Requirements

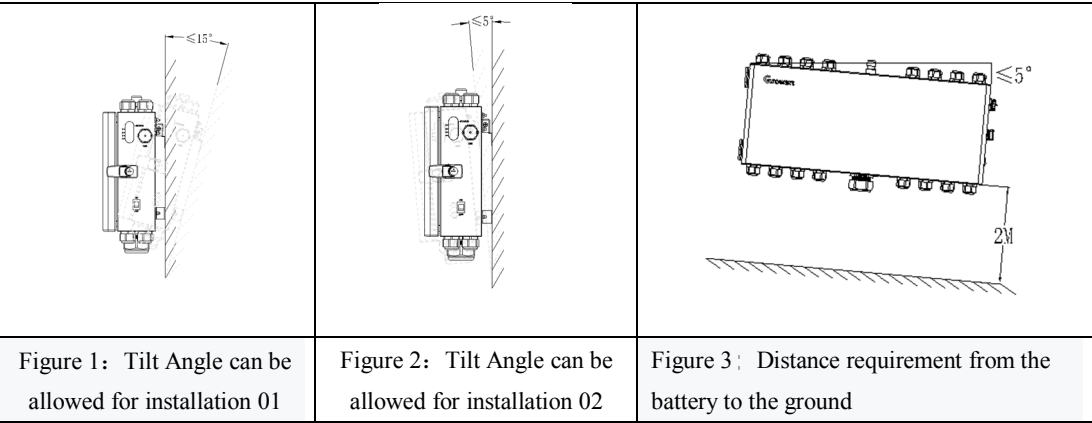

Note: ARK LV HUB-A1 is installed on the wall and the installation angle required above.

2.2. Installation procedure

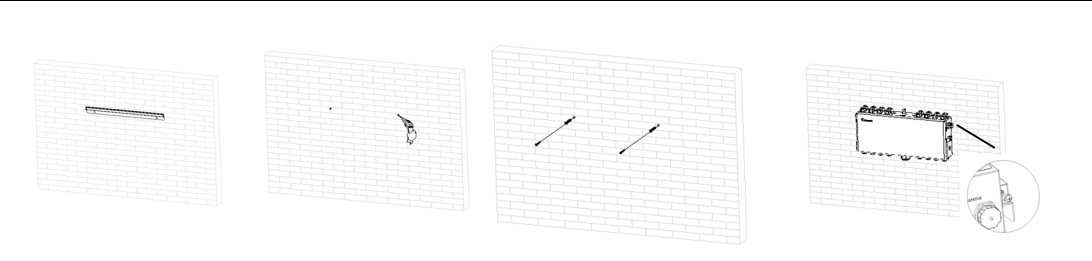

1. Please make sure that the thickness of the wall for ARK LV HUB-A1 installations more than 120mm;
2. Place the wall hangers on the wall and mark the holes that need to be punched;
3. Remove the wall hangings and drill a hole with a depth of 55mm at the mark with a drill of φ8;
4. Expand the bolt with a hammer into the hole in the wall, install the nut (including elastic flat pad and tighten the nut with a wrench).
5. Hang the ARK LV HUB-A1 on the wall hangers.
6. Install the safety screws on both sides

3. System Diagram

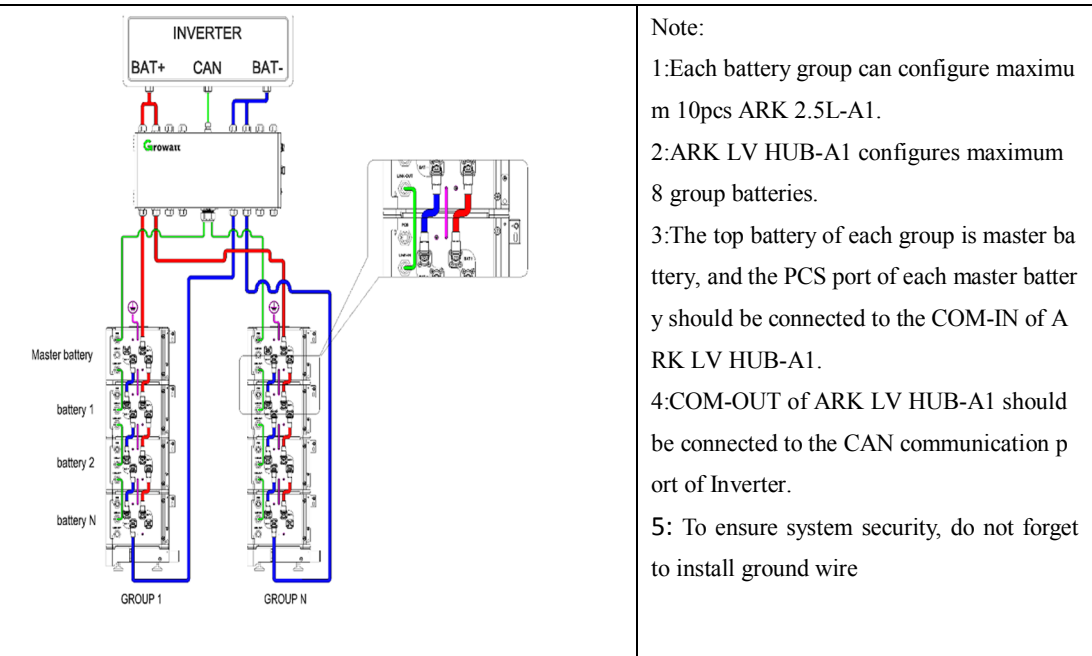

- Note:
- 1: Each battery group can configure maximum 10pcs ARK 2.5L-A1.
 - 2: ARK LV HUB-A1 configures maximum 8 group batteries.
 - 3: The top battery of each group is master battery, and the PCS port of each master battery should be connected to the COM-IN of ARK LV HUB-A1.
 - 4: COM-OUT of ARK LV HUB-A1 should be connected to the CAN communication port of Inverter.
 - 5: To ensure system security, do not forget to install ground wire

Figure 4: System Diagram of battery Groups system.

4. Electrical wiring

4.1 Power line and Communication line connection

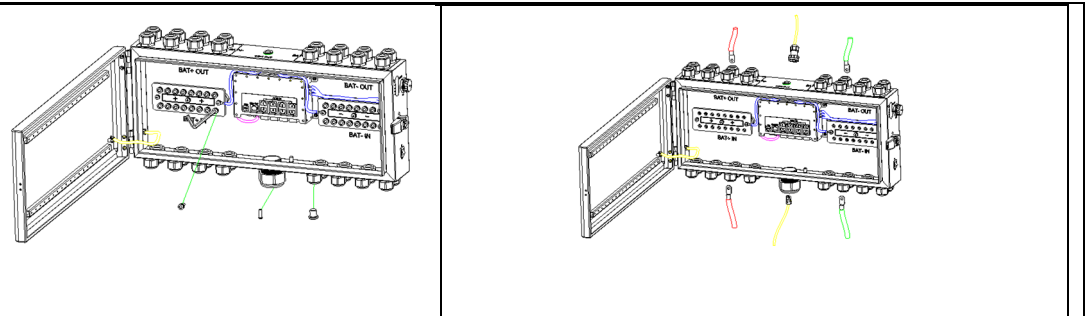

Figure 5: Remove screws and plugs Figure 6: Connect power line and communication line

1. Open the cover using the key if necessary, and then remove screws and plugs as is shown in Figure 5.
2. Connect power line and communication line of ARK LV HUB-A1.

4.2. Communication line connection of battery

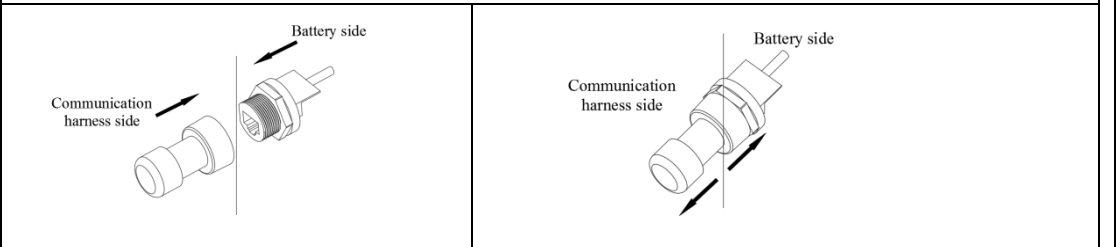

Figure 7: Connect Communication terminal Figure 8: Disconnect Communication terminal

1. Parallel communication is the connection between the middle communication plug of the first module and the lower communication plug of the next module as is shown in Figure 8.
2. The uppermost communication plug of the top battery module is connected to COM-IN.

4.3. Power line connection of battery

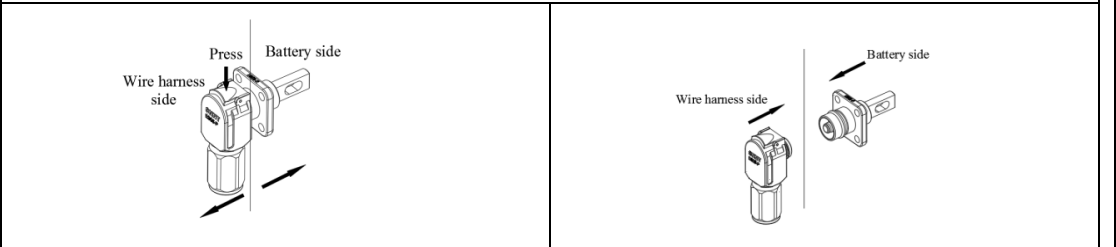

Figure 9: Connect power terminals of battery Figure 10: Disconnect power terminals of battery

1. When the power wiring harness is connected, please pay attention to the positive and negative terminals, the red terminals are connected to the positive terminals and the black terminals to the negative terminals.
2. Press the position indicated in the figure above before disconnecting the power terminal.

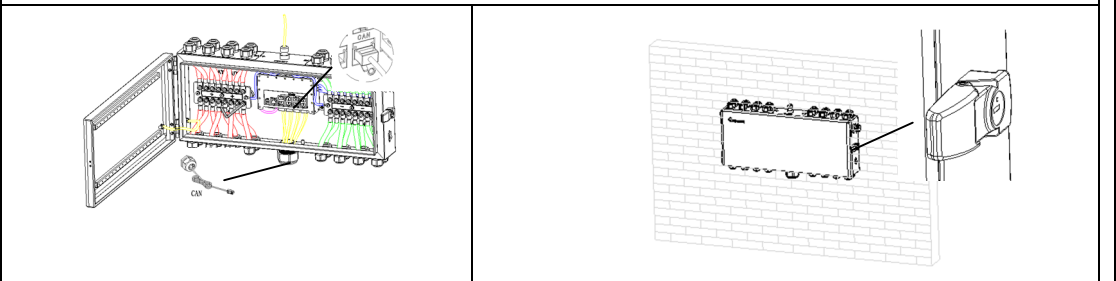

Figure 11: Tighten the screws and connect the communication line. Figure 12: Close the cover and lock it.

- Note:
- 1: The battery is not allowed to be installed in the running state, and all the RUN lights of battery modules should be off before installation.
 - 2: To ensure system security, do not forget to install ground wire
 - 3: When the power wiring harness is connected, please pay attention to the positive and negative terminals, the red terminals are connected to the positive terminals and the black terminals to the negative terminals.
 - 4: Press the position indicated in the figure above before disconnecting the power terminal.

6. Key operation

6.1 Power switch of ARK LV HUB-A1

Situation	description	
ON	Power on ARK LV HUB-A1 if the battery has voltage output	
OFF	Shut down ARK LV HUB-A1	

6.2 Power Button of Battery

Situation	Touch	Situation	
When the system is shut down	Press(≤2S)	No reaction	
	Press(≥2S)	Power on	
When the system is on	Press(≥1S)	Shut down	

- Note:
- 1: The power supply of ARK LV HUB-A1 is the battery output, and if the battery has no voltage output, ARK LV HUB-A1 can't power on.
 - 2: Power On the ARK battery Groups system, First you should press power switch of ARK LV HUB-A1 in ON status, and then you just need to press the key of any battery to start.
 - 3: Power Off the ARK battery Groups system, First you should press the key of any battery to Off, and then you just need to press power switch of ARK LV HUB-A1 in OFF status

