

Wireless 1 & 2-Way PIR PET Detector



Model: EL5845PI



Installation Instructions

Description

The EL5845PI is a battery powered 1 & 2-Way wireless PIR PET detector that is compatible with RISCO's 2-Way security systems.

Features include:

- 12m coverage (wide angle) with 90° field-of-view
- Installation height 2.1-2.2m
- 1-Way / 2-Way RF option (DIP switch selectable)
- 2 long-life lithium batteries for extended battery life
- Frequency: 868Mhz or 433Mhz
- PET Immunity (45Kg animals)

Installation

Step1: Selecting a Mounting Location

Select the mounting location for best coverage of the area that is to be protected (see *Preliminary Considerations and Coverage Patterns*).

Step 2: Registering the Detector in the System

The detector must identify itself to the system's receiver (control panel) during the registration process.

1. Set the system to registration mode.
2. Go to the main menu and select [9] Programming > [1] Devices > [1] Zones.
3. Select a zone and press '✓'. The system enters into Learn mode.
4. Unlock and remove the mounting bracket from the detector (see *Figure 1 and Figure 3*).

5. Set the detector DIP switch settings (see *Figure 3 and DIP Switch Settings*).
6. Insert the supplied batteries into the battery holders paying attention to the correct polarity or remove the plastic protector strip if the batteries are already in place (see *Figure 3*).

The detector sends a transmission to the system. If the transmission is successfully received by the system it plays a confirmation sound.

If no confirmation sound is heard, send another transmission by pressing and releasing the tamper switch of the device (see *Figure 3*).

Once the detector is successfully registered the system display shows: Save?

7. Press '✓' to confirm and continue entering other parameters for the chosen device (see *Parameter Configuration*).

Step 3: Deleting the Detector in the System

To delete a detector in the system, perform the following procedure:

1. Go to the Installer menu and select zone >12> ✓ (quick key: 9>1>1>Zone#>12).
2. Open the detector and remove the battery.
3. Press the tamper switch down.
4. Put back the battery (while the tamper is being pressed).
5. Within 5 seconds, release the tamper switch and press down again.

Step 4: Mounting the Detector

The detector must be tested on the exact mounting position before permanently mounting.

1. Open the knockout holes of the mounting bracket, and use them as a template for mounting (see *Figure 2*).

NOTE: For use of back tamper, use at least one screw for back-tamper wall mount or corner mount (see *Fig 2*).

In order to optimize pet immunity, always mount the detector vertically at a right angle to the floor. Make sure that an animal cannot get above the height of 1.5m (5') by climbing on furniture, shelving or stairs.

2. Once the bracket is installed, slide and lock the detector onto the mounting bracket.
3. Perform a Walk Test (see *Performing a Walk Test*).
4. Insert and fasten screw into the hole located at the bottom of the detector to lock the detector to the mounting bracket (see *Figure 4*).

Step 5: Performing a Walk Test

The detector needs approximately 90 seconds to warm up after applying power.

Go to the systems main menu and select [7] Service > [6] Walk Test and press '✓'.

During Walk Test mode, walk through the entire field of view of the detector and confirm that the LED activates and deactivates accordingly (see *LED Indication*).

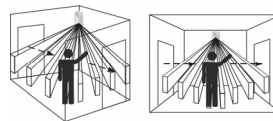

Verify that the system receives the signals.

NOTE: Wait for ten seconds, after each detection, before continuing the test.

After completing the walk test, reset the system to Normal mode.

LED Indication

Status	Indication
On (in alarm mode)	Detection alarm
Blinking twice (in alarm mode):	Low battery
Blinking four times (in learning mode)	Successful registration

DIP Switch Settings

1-Way parameters can be modified from the DIP switch.

DIP	Function	Option
1	1-Way / 2-Way	OFF (1-Way / ON (2-Way)*
2	LED	OFF / ON*
3	Sensitivity	OFF (Low)* / ON (High)
4	Normal / Walk Test	OFF (Normal, 2,5 min)* / ON (Walk Test)

* = Default

Parameter Configuration

2-Way parameters can be modified from the system.

Go to the main menu and select [9] Programming > [1] Devices > [1] Zones > [11].Sensor Par.

LED:	Enable* / Disable
PIR Sensitivity:	Low* / High
Alarm Delay:	1-20 minutes (3 mins.*)

* = default

For additional information refer to the *System Installer Manual*.

Diagnostics

You can perform diagnostic tests on your detector using the system. Diagnostics includes testing the detector battery status and the communication between the detector and the system.

For additional information refer to the *System Installer Manual*.

Battery Replacement

1. Unlock and slide the detector from the mounting bracket.
2. Replace the batteries paying attention to the correct polarity.
3. Slide and lock the detector to the mounting bracket.

CAUTION – Risk of explosion if battery is replaced by an incorrect type. Dispose of used batteries according to local regulations.

Specifications

Electrical	
Battery Type:	2 x CR 123, 3V Lithium
Battery Life:	2 batteries – 3 year typical lifetime
Current Consumption:	58 µA standby; 30mA max.
Supervision:	1-Way:
Transmission:	<ul style="list-style-type: none"> • 433 MHz – 67 min. • 868 MHz – 10 min. 2-Way: 0-255 minutes
RF transmitting frequencies:	868MHz, 433MHz - model EL5845PI
Optical	
Filtering:	White Light Protection
Pet friendly:	Up to a 45 kg animal immunity (pet model)
Physical	
Size (L x W x D):	120 x 65 x 35 mm (4.7 x 2.6 x 1.8 in)
Weight:	100 grams (3.52 oz.)
Environmental	
RF Immunity:	According to EN50130-4
EL5845PI Standard compliance:	EN50131-2-2 Grade 2 Environmental Class II EN50131-6 Type C
Low Battery Threshold:	2.7V
Output Power:	10mW
Operating Temperature:	-10°C a 55°C (14°F a 140°F)
Storage Temperature:	-20°C a 60°C (-4°F a 140°F)

Preliminary Considerations

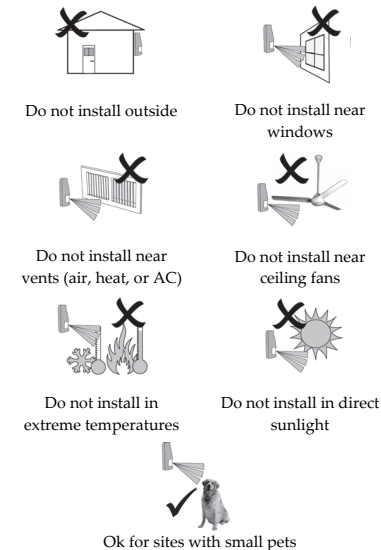

PIR Coverage Patterns

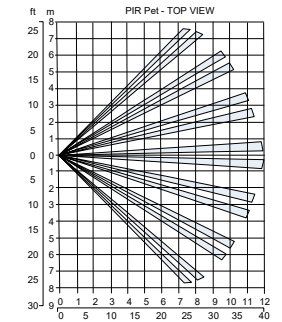
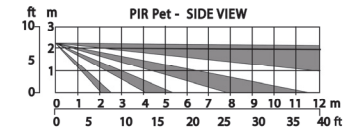

Quick Install



Figure 1

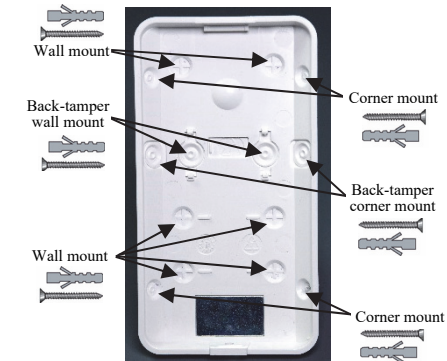

Figure 2

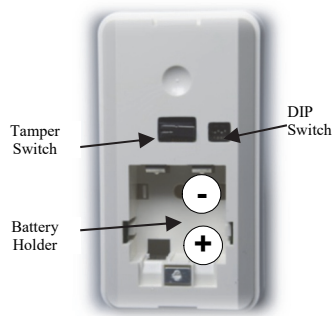

Figure 3



Figure 4

Ordering Information

E8USX45PET0A	EL5845PI 1&2Way PET,
E4USX45PET0A	868MHz / 433MHz

RED Compliance Statement:

Hereby, RISCO Group declares that this product is in compliance with the essential requirements and other relevant provisions of Directive 2014/53/EU. The declaration of conformity may be consulted at www.riscogroup.com

Standard Limited Product Warranty

RISCO Ltd., its subsidiaries and affiliates (“Risco”) guarantee Risco’s hardware products to be free from defects in materials and workmanship when used and stored under normal conditions and in accordance with the instructions for use supplied by Risco, for a period of (i) 24 months from the date of connection to the Risco Cloud (for cloud connected products) or (ii) 24 months from production (for other products which are non-cloud connected), as the case may be (each, the “Product Warranty Period” respectively).

Contact with customers only. This Product Warranty is solely for the benefit of the customer who purchased the product directly from Risco, or from any authorized distributor of Risco. Nothing in this Warranty obligates Risco to accept product returns directly from end users that purchased the products for their own use from Risco’s customer or from any installer of Risco, or otherwise provide warranty or other services to any such end user. Risco customer shall handle all interactions with its end users in connection with the Warranty, inter alia regarding the Warranty. Risco’s customer shall make no warranties, representations, guarantees or statements to its customers or other third parties that suggest that Risco has any warranty or service obligation to, or any contractual privity with, any recipient of a product. Return Material Authorization. In the event that a material defect in a product shall be discovered and reported during the Product Warranty Period, Risco shall, at its option, and at customer’s expense, either:

(i) accept return of the defective Product and repair or have repaired the defective Product, or (ii) accept return of the defective Product and provide a replacement product to the customer. The customer must obtain a Return Material Authorization (“RMA”) number from Risco prior to returning any Product to Risco. The returned product must be accompanied with a detailed description of the defect discovered (“Defect Description”) and must otherwise follow Risco’s then-current RMA procedure in connection with any such return. If Risco determines in its reasonable discretion that any Product returned by customer conforms to the applicable warranty (“Non-Defective Products”), Risco will notify the customer of such determination and will return the applicable Product to customer at customer’s expense. In addition, Risco may propose and assess customer a charge for testing and examination of Non-Defective Products.

Entire Liability. The repair or replacement of products in accordance with this warranty shall be Risco’s entire liability and customer’s sole and exclusive remedy in case a material defect in a product shall be discovered and reported as required herein. Risco’s obligation and the Warranty are contingent upon the full payment by customer for such Product and upon a proven weekly testing and examination of the product functionality.

Limitations. The Product Warranty is the only warranty made by Risco with respect to the Products. The warranty is not transferable to any third party. To the maximum extent permitted by applicable law, the Product Warranty does not apply and will be void if: (i) the conditions set forth above are not met (including, but not limited to, full payment by customer for the product and a proven weekly testing and examination of the product functionality); (ii) if the Products or any part or component thereof: (a) have been subjected to improper

operation or installation; (b) have been subject to neglect, abuse, willful damage, abnormal working conditions, failure to follow Risco’s instructions (whether oral or in writing); (c) have been misused, altered, modified or repaired without Risco’s written approval or combined with, or installed on products, or equipment of the customer or of any third party; (d) have been damaged by any factor beyond Risco’s reasonable control such as, but not limited to, power failure, electric power surges, or unsuitable third party components and the interaction of software therewith or (e) any delay or other failure in performance of the product attributable to any means of communications, provided by any third party service provider (including, but not limited to) GSM interruptions, lack of or internet outage and/or telephony failure.

BATTERIES ARE EXPLICITLY EXCLUDED FROM THE WARRANTY AND RISCO SHALL NOT BE HELD RESPONSIBLE OR LIABLE IN RELATION THERETO, AND THE ONLY WARRANTY APPLICABLE THERETO, IF ANY, IS THE BATTERY MANUFACTURER’S WARRANTY.

Risco makes no other warranty, expressed or implied, and makes no warranty of merchantability or of fitness for any particular purpose. For the sake of good order and avoidance of any doubt:

DISCLAIMER. EXCEPT FOR THE WARRANTIES SET FORTH HEREIN, RISCO AND ITS LICENSORS HEREBY DISCLAIM ALL EXPRESS, IMPLIED OR STATUTORY, REPRESENTATIONS, WARRANTIES, GUARANTEES, AND CONDITIONS WITH REGARD TO THE PRODUCTS, INCLUDING BUT NOT LIMITED TO ANY REPRESENTATIONS, WARRANTIES, GUARANTEES, AND CONDITIONS OF MERCHANTABILITY, FITNESS FOR A PARTICULAR PURPOSE, TITLE AND LOSS OF DATA. WITHOUT LIMITING THE GENERALITY OF THE FOREGOING, RISCO AND ITS LICENSORS DO NOT REPRESENT OR WARRANT THAT: (I) THE OPERATION OR USE OF THE PRODUCT WILL BE TIMELY, SECURE, UNINTERRUPTED OR ERROR-FREE; (ii) THAT ANY FILES, CONTENT OR INFORMATION OF ANY KIND THAT MAY BE ACCESSED THROUGH THE PRODUCT BY CUSTOMER OR END USER SHALL REMAIN SECURED OR NON DAMAGED. CUSTOMER ACKNOWLEDGES THAT NEITHER RISCO NOR ITS LICENSORS CONTROL THE TRANSFER OF DATA OVER COMMUNICATIONS FACILITIES, INCLUDING THE INTERNET, GSM OR OTHER MEANS OF COMMUNICATIONS AND THAT RISCO’S PRODUCTS, MAY BE SUBJECT TO LIMITATIONS, DELAYS, AND OTHER PROBLEMS INHERENT IN THE USE OF SUCH MEANS OF COMMUNICATIONS. RISCO IS NOT RESPONSIBLE FOR ANY DELAYS, DELIVERY FAILURES, OR OTHER DAMAGE RESULTING FROM SUCH PROBLEMS. RISCO WARRANTS THAT ITS PRODUCTS DO NOT, TO THE BEST OF ITS KNOWLEDGE, INFRINGE UPON ANY PATENT, COPYRIGHT, TRADEMARK, TRADE SECRET OR OTHER INTELLECTUAL PROPERTY RIGHT

IN ANY EVENT RISCO SHALL NOT BE LIABLE FOR ANY AMOUNTS REPRESENTING LOST REVENUES OR PROFITS, PUNITIVE DAMAGES, OR FOR ANY OTHER INDIRECT, SPECIAL, INCIDENTAL, OR CONSEQUENTIAL DAMAGES, EVEN IF THEY WERE FORESEEABLE OR RISCO HAS BEEN INFORMED OF

THEIR POTENTIAL.

Risco does not install or integrate the product in the end user security system and is therefore not responsible for and cannot guarantee the performance of the end user security system which uses the product.

Risco does not guarantee that the product will prevent any personal injury or property loss by burglary, robbery, fire or otherwise; or that the product will in all cases provide adequate warning or protection. Customer understands that a correctly installed and maintained alarm may only reduce the risk of burglary, robbery or fire without warning, but is not an assurance or a guarantee that such an event will not occur or that there will be no personal injury or property loss as a result thereof. Consequently Risco shall have no liability for any personal injury, property damage or loss based on a claim that the product fails to give warning. No employee or representative of Risco is authorized to change this warranty in any way or grant any other warranty.

Contacting RISCO International Headquarters:

RISCO Ltd.

14 Hachoma St., 75655

Rishon Le Zion, Israel

Tel: (+972-3) 963-7777

Please visit us at: www.riscogroup.com



Copyright 2018, RISCO Ltd. All rights reserved

10/2018 5IN2455 E